

# TREE PRESERVATION

Tree Diameter (in.)	Tree Species	Tree ID#:
12"	Cedar	7,196
12"	Oak	66,131
12"	Pine	1,3,23,27,217,218,220,227,228,234
12"	Sycamore	79,115
12"	Sweetgum	57,106,145,184
13"	Cedar	2,5
13"	Oak	55
14"	Pine	21,172,213,224,225
14"	Sweetgum	31
15"	Cedar	136
15"	Oak	61,69
15"	Pine	36,58,155,178,182,214,231,236,240
15"	Poplar	42,77
15"	Sycamore	96
15"	Sweetgum	104,113,117,221,229
16"	Sycamore	149
17"	Sycamore	107
18"	Cedar	215
18"	Hickory	4
18"	Oak	70,72
18"	Pine	32,137,156,183,216,219,226,233,235
18"	Sweetgum	50,77,112,116,167
20"	Sweetgum	114,179
22"	Poplar	78,105
22"	Sycamore	109
24"	Hickory	5
24"	Oak	65
24"	Pine	60,62,63,74,80,212,232,237
24"	Sweetgum	49,108
30"	Maple	82
36"	Pine	222,223,230

## TREE PRESERVATION CALCULATIONS:

NEIGHBORHOOD EDGE (NE)  
 PROJECT SITE AREA: 240,871 SF (5.53 AC)  
 TOTAL NO. EXISTING TREES (12" AND ABOVE) = 222 TREES  
 EXISTING MATURE TREE CANOPY\* = 222,000 SF  
 REQUIRED TREE SAVE = 88,800 SF (40%)  
 PROPOSED TREE SAVE (12" AND ABOVE) = 89,000 SF (40%)

\*TREE CANOPY CALCULATIONS ASSUME AVERAGE CANOPY AREA OF 1,000 SF/LARGE MATURING TREE AND 200 SF/SMALL MATURING TREE PER DPO 9.3.1.

## TREE COVERAGE CALCULATIONS:

NEIGHBORHOOD EDGE (NE)  
 PROJECT AREA FOR MINIMUM CANOPY COVERAGE<sup>1</sup>  
 TOTAL SITE AREA 240,871 SF  
 -STREET/ALLEY ROW 30,798 SF  
 -MULTI-USE PATH 13,978 SF  
 -BMP/BMP ACCESS 17,825 SF  
 = 178,270 SF  
 MINIMUM PROJECT CANOPY COVERAGE<sup>2</sup> = 89,135 SF (50% OF PROJECT AREA)  
 TREE PRESERVATION 89 TREES 89,000 SF  
 PROPOSED STREET TREES 32 TREES 6,400 SF  
 PROPOSED SMALL MATURING 3 TREES 600 SF  
 = 96,000 SF (54%)

<sup>1</sup> PROJECT AREA FOR MINIMUM CANOPY COVERAGE IS SUBJECT TO CHANGE BASED ON THE POTENTIAL FOR PLANTINGS WITHIN THE BMP.

<sup>2</sup> TREE CANOPY CALCULATIONS ASSUME AVERAGE CANOPY AREA OF 1,000 SF/LARGE MATURING TREE AND 200 SF/SMALL MATURING TREE PER DPO 9.3.1.

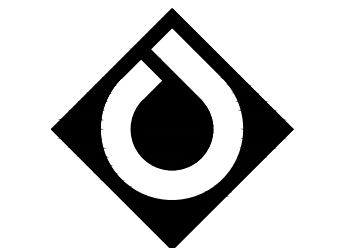
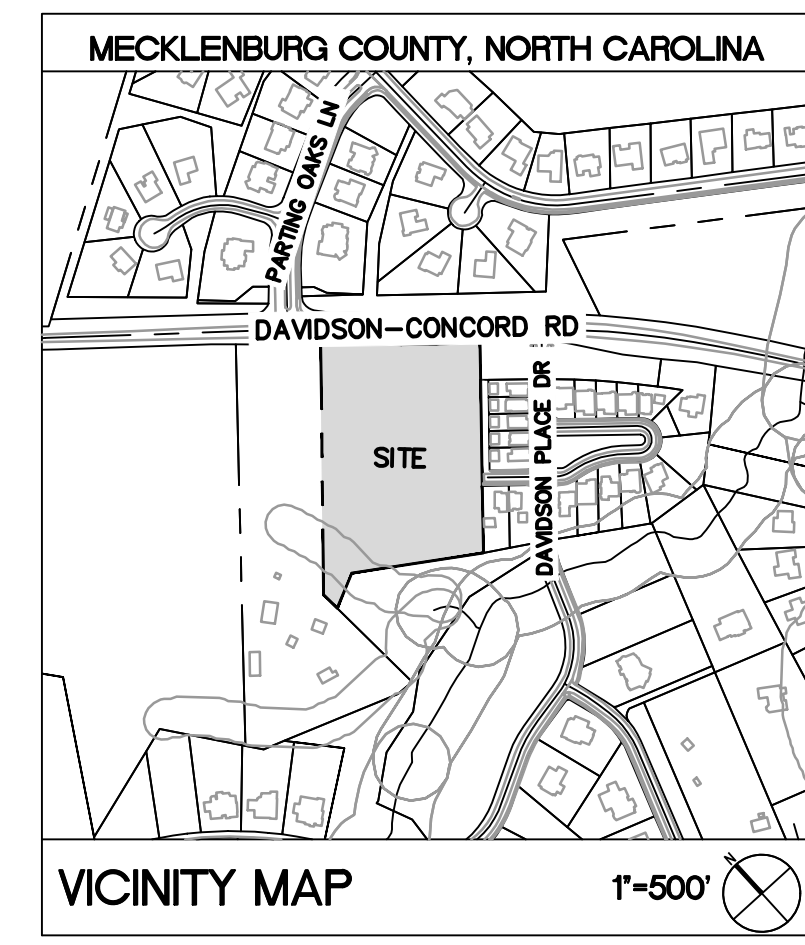

**ColeJenest & Stone**

Shaping the Environment  
 Realizing the Possibilities

Land Planning  
 + Landscape Architecture  
 Civil Engineering  
 + Urban Design

200 South Tryon Street, Suite 1400  
 Charlotte, North Carolina 28202  
 p+ 704.376.1555 f+ 704.376.7851  
 url+ www.colejeneststone.com

**PALILLO HOLDINGS, LLC.**

18611 STARCREEK DR  
 CORNELIUS, NC 28031

**18647 DAVIDSON  
 CONCORD RD**

18647 DAVIDSON-CONCORD RD  
 DAVIDSON, NC 28036

**SCHEMATIC  
 LANDSCAPE  
 PLAN**

Project No.  
 4680

Issued  
 10/02/2020

Revised

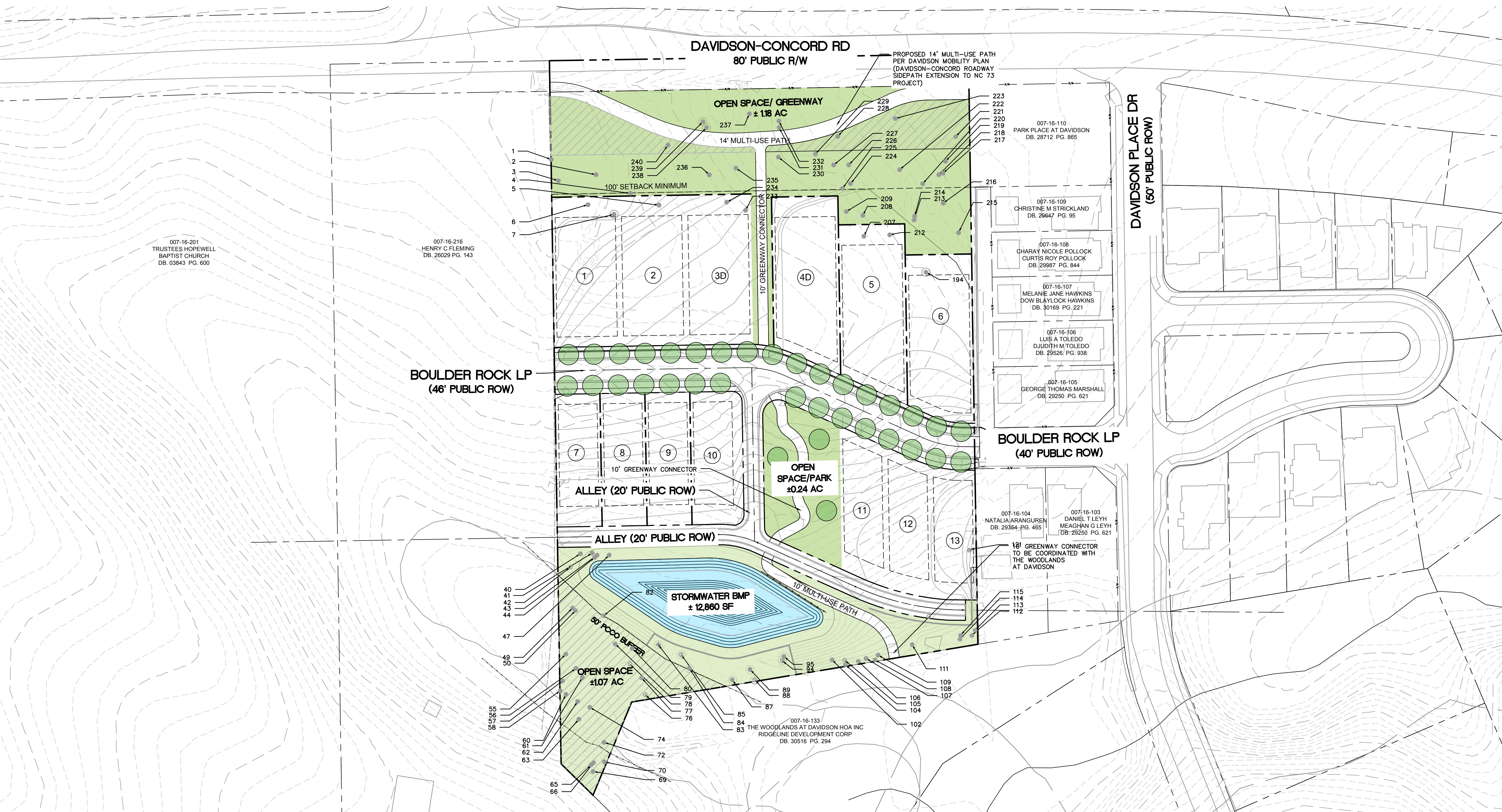

## LEGEND

- SYMBOL
- SMALL MATURING TREES (25' O.C.)
  - PARK SPACE
  - OPEN SPACE
  - UNDISTURBED OPEN SPACE

PLANTING AND TREE REQUIREMENTS PER ORDINANCE TABLE 9-1 AND TABLE 9-2 OF ORDINANCE REGARDING TREE CANOPY COVERAGE AND TREE PLANTING REQUIREMENT.

NOTE: 5' LANDSCAPE BUFFER TO BE PROVIDED AROUND THE PERIMETER OF THE PROPERTY.

SCALE: 1"=50'  
 0 25' 50' 100'

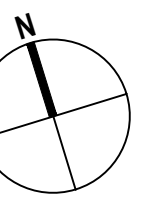

- CONTRACTOR IS FULLY RESPONSIBLE FOR CONTACTING APPROPRIATE PARTIES AND ENSURING THAT ALL EXISTING UTILITIES ARE LOCATED PRIOR TO CONSTRUCTION.
- CONTRACTOR IS RESPONSIBLE FOR PLACING BARRICADES, USING FLAG MEN, ETC., AS NECESSARY TO ENSURE THE SAFETY OF THE PUBLIC.
- ALL PAVEMENT CUTS, CONCRETE OR ASPHALT, ARE TO BE REPLACED ACCORDING TO THE STANDARDS OF THE NORTH CAROLINA DEPARTMENT OF TRANSPORTATION, OR LOCAL JURISDICTION, WHICHEVER IS MORE STRINGENT.
- SHORING SHALL BE IN ACCORDANCE WITH OSHA TRENCHING STANDARDS, 29 CFR, PART 1926, SUBPART P, OR AS AMENDED.

**MP-04**

The drawings, the project manual and the design shown thereon are instruments of ColeJenest & Stone, P.A. The reproduction or unauthorized use of the documents without consent of ColeJenest & Stone, P.A. is prohibited.

ColeJenest & Stone, P.A. 2020 ©